

Pynefloor™

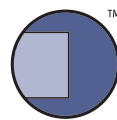

Pynefloor™
STRAIGHT EDGE™

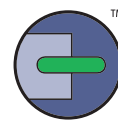

Pynefloor™
GREEN TONGUE™



Pynefloor™
GOLD™

another trade essential from
THE **laminex** GROUP™

Introduction

Trade Essentials® Pynefloor™ is a high density three layered particleboard bonded with moisture resistant resin and wax, specifically formulated for use as residential and commercial interior floor platforms. When installed and maintained in accordance with this brochure, it will comply with the sheet flooring requirements of the New Zealand Building Code.

Product Description

Pynefloor™ particleboard flooring has a plain core colour with a yellow wax edge seal to all edges. There are three product choices to cover your building requirements:

Pynefloor™ Straight Edge™ is an all-purpose 20mm nominal thick wood based high density square edged particleboard.

Pynefloor™ Green Tongue™ is identical to Pynefloor Straight Edge in its manufacture but has the enhancement of a polypropylene tongue that gives the required sheer strength and eliminates the need for solid timber nogs to the long edge.

Pynefloor™ Gold™ is the premium particleboard available in 22mm. Increased strength through improved resin composition helps provide a more substantial floor with the added benefit of increased weathering performance.



Pynefloor™
STRAIGHT EDGE™



Pynefloor™
GREEN TONGUE™



Pynefloor™
GOLD™

Table 1

Product Range				
	Panel Sizes	Weight (kg) per panel	Panels per pack	Weight (kg) per pack
Straight Edge	3600 x 1800	89	12	1073
	2400 x 1200	40	45	1788
Green Tongue	3600 x 1800	89	12	1073
	3600 x 1200	60	18	1073
	3600 x 900	45	25	1118
	2400 x 1200	40	45	1788
Gold	3600 x 900	49	25	1225

Flooring Guide - What product to use?

Figure 1

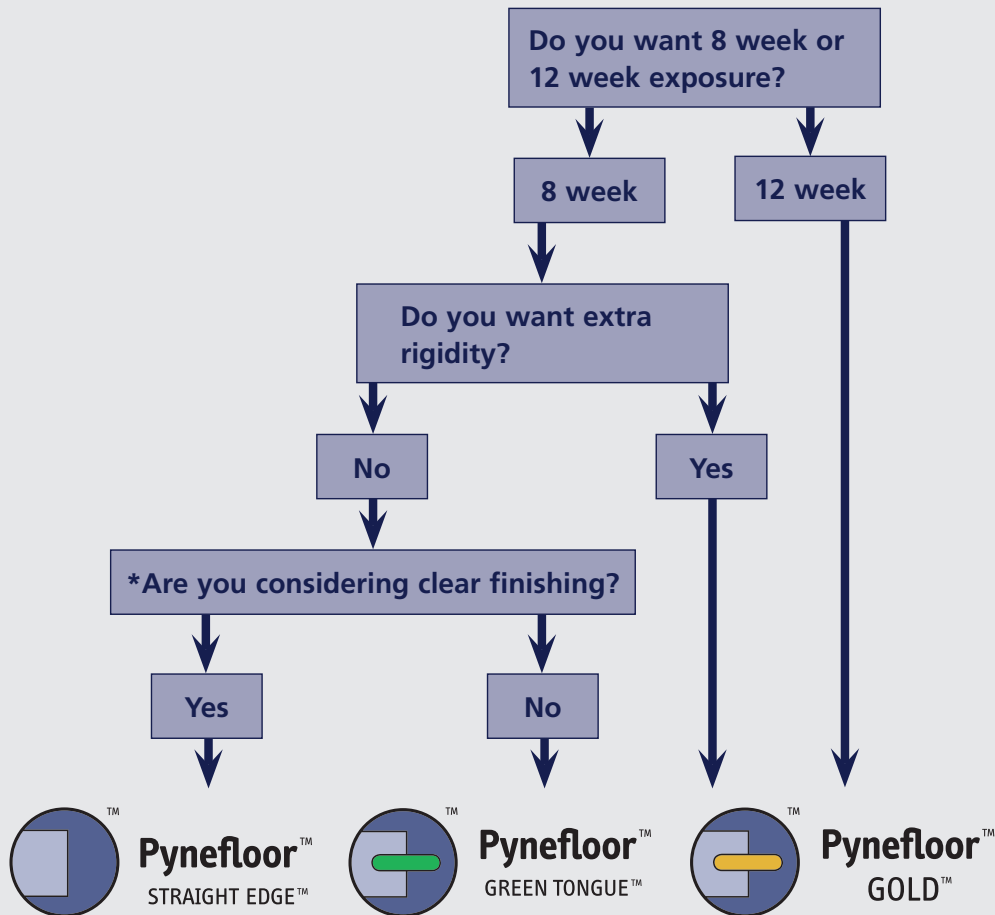

*Please refer to Clear Finishing section for specific details about possible visual imperfections

Installation

Panel Layup

Pynefloor™ Green Tongue™ and Pynefloor™ Gold™:

- Place face with ink marked brand name downwards.
- Use a string line when laying the first row of panels (see Figure 2).
- To allow for linear expansion, a minimum 8mm clearance must be provided between panel edges and fixed objects such as bottom plates, columns, abutting concrete etc.
- Provide continuous edge support at building perimeter.
- Panels must be laid across the joists (see Figure 3).
- Sheet end joints should be staggered (see Figure 3).
- Edges must be close butted – do not cramp.
- Cut panels must span a minimum of three joists.
- Provide continuous support to tongue and groove edge in wet areas where rigid floor finishes are used – ceramic tiles etc.

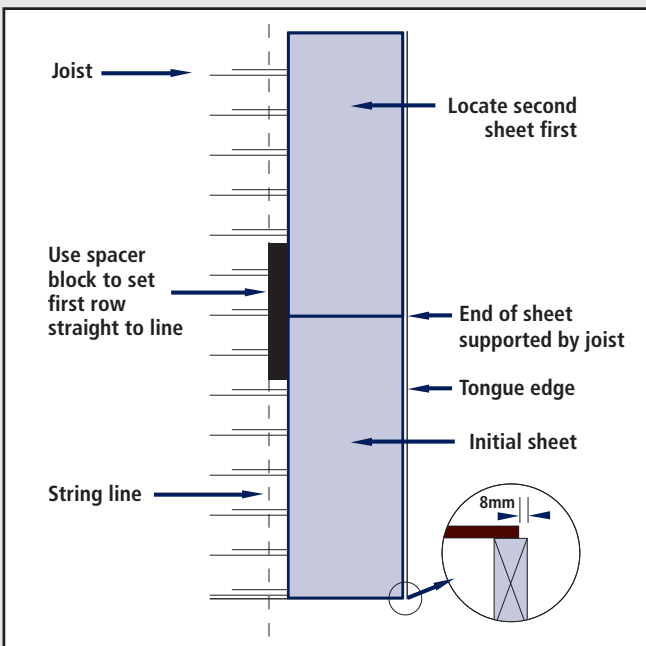

Figure 2

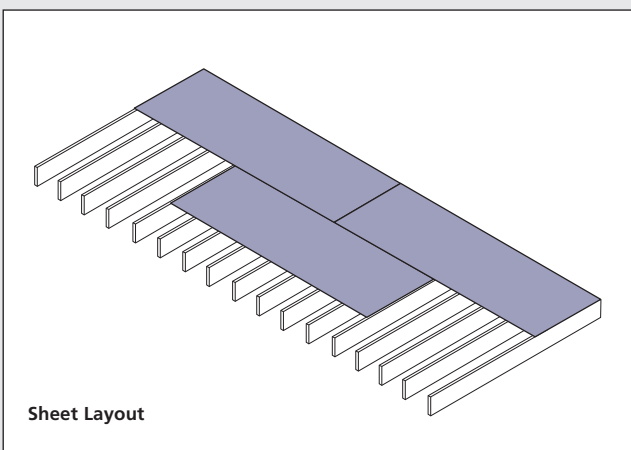

Figure 3

Pynefloor™ Straight Edge™:

- Panel layup consistent with Pynefloor Green Tongue and Pynefloor Gold except fixing of nogs/dwanggs between joists is necessary to provide support to long edge of panel.

Fixing

- All nails must be hot dip galvanised.
- All nails must be punched below the surface just prior to sanding.
- Staple fastening must not be used.

Table 2

Timber Joists	Minimum Size	Fixing Centres mm	
		(Edges)	(Intermediate)
Annular grooved particle board flooring nails	60mm	150	200
Galvanized Jolt head nails	60mm	150	200
Type 17 countersunk self drilling screws	45mm x8 gauge	150	200
Steel Joists			
Tek self drilling screw (corrosion resistant)	50mm x12 gauge	150	200
Adhesive			
Flexible solvent based elastomeric construction adhesive		5mm bead to the top of each joist. 2mm bead to the top of tongue.	

- For Pynefloor Green Tongue and Pynefloor Gold, all fastenings are to be 15mm from the edge of the panel to clear tongue and groove profile and 10mm in from ends supported by joists.
- For Pynefloor Straight Edge all fastenings are to be placed 10mm from the edge and ends of the panel.
- For diaphragms, double fixings are required as shown in Figure 4. The maximum joist spacing is 450mm and sheet end joints must be staggered. **Please Note:** Screw fixing is currently acceptable for non-diaphragm applications only.

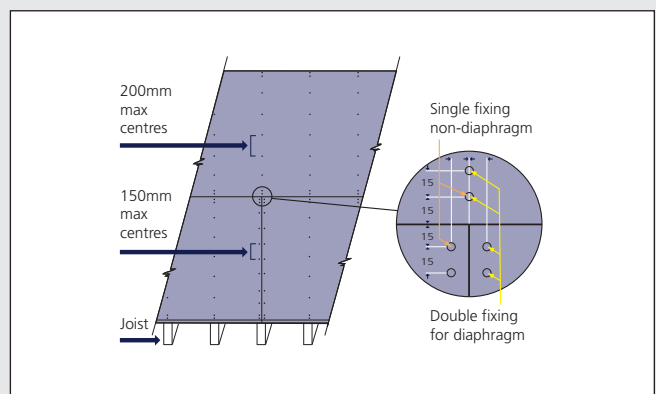

Figure 4

Installation

Nail Fastenings

Hand-driven nails

- Initially be driven flush with the surface.
- Punch nails just prior to sanding. This allows for moisture content of joists to dry during building construction. Punching the nail will close up any gaps between the flooring panel and the joist.
- To improve lateral holding, nails shall be slightly angled and driven parallel to the sheet edge.

Power-Driven Nails

- Use a depth adjuster on the power tool to control depth of nail.
- Initial nailing flush with the surface.
- Ensure punching takes place just prior to sanding and finishing.

NOTE:

- Avoid nailing too close to the edge of the panel.
- Hand-driven nail fastening generally provides a better finish as greater control of the process is possible.

Finishing

Pynefloor provides an ideal substrate for most types of floor finishes.

- Pynefloor surfaces facing the habitable space must be covered or coated prior to occupation of the structure.
- All floors will require sanding prior to covering or coating.
- The moisture content of the flooring must be checked prior to the application of any covering or coating. The maximum moisture content must not exceed 15% especially at panel edges. Failure to comply may result in an unsatisfactory visual appearance due to panel movement as drying occurs.
- All Pynefloor Green Tongue and Pynefloor Gold tongue and groove joints must be supported by solid timber or the floor area overlaid with a tile underlay sheet material where ceramic tiles are to be laid.

Note:

Excessive sanding or using very coarse sandpaper aggressively will reduce the thickness of the panels thereby affecting the strength. Colour variations between sheets may also occur.

Wet Area Floors

A wet area floor is any area which is supplied with water from a water supply system e.g. kitchens, bathrooms, toilets, shower rooms, laundries, changing rooms, en-suites etc.

The Pynefloor in these areas must be protected by an integrally waterproof sheet material (e.g. polyvinylchloride) with sealed joints; or an appropriate⁽¹⁾ wet area membrane which is then protected with a floor covering of your choice.

(1) An appropriate wet area membrane is one that complies with AS/NZS 4858 or which carries a current BRANZ Appraisal.

An impervious coating such as polyurethane or paint is not an acceptable finish in these areas.

Please refer to Trade Essentials Technical Bulletin: *Pynefloor Particleboard in Wet Area Floors* for full instructions.

Clear Finishing (polyurethane)

Pynefloor Straight Edge must be used where clear finish is intended.

There may be visual imperfections in the surface of the particleboard after clear finishing. The finished result may or may not meet customer expectations. Refer to indicative image in Figure 5. For further images and instructions, please refer to the website and the Pynefloor Technical Manual Section 10.2.3.



Figure 5 Indicative visual imperfections after clear finishing

Batches of Pynefloor must not be mixed – check underside of sheets for batch numbers.

Polyurethane or paint coatings are not acceptable finishes in wet areas.

Plan-A-Floor

Plan-A-Floor can be found at www.thelaminexgroup.co.nz in the 'Tools' section. Developed to help the user select and lay out flooring panels it produces a solution, and allows the user to make adjustments to the design in a number of different ways.

The package is simple to use, giving the total number and sizes of panels, the number and weight of nails required and the quantity of adhesive needed (if used). The finished design and material schedule can then be printed for ordering and on-site use.

Uses

Pynefloor products are suitable to be used to form platform floors within the scope limitations of NZBC Acceptable Solution E2/AS1 Paragraph 1.1. Any other uses may require specific design.

Pynefloor can be used for all of the following applications:

- As pre-laid or post-laid flooring over timber and IBeams such as IBUILT™ Structural Flooring Solutions or steel joists, in single or double layer applications.
- As an overlay to concrete or wooden floors.
- As floor diaphragms for wind and earthquake loads.
- For general staircase construction.
- For industrial shelving and packaging.

Design Considerations

For domestic housing (as per NZS 3604 1.1.2 (e) (i)), joist support centres up to 600mm are acceptable. If a more rigid floor is required, Pynefloor Gold should be used or supports reduced to 450mm maximum.

For all other non-domestic applications (i.e. residential, institutional, educational and other buildings) joist spacings shall not exceed:

- For Pynefloor Straight Edge and Green Tongue – 450mm centres
- For Pynefloor Gold - 600mm centres

Please note: Additional panel support will be required for concentrated loads (point loads) such as pianos, billiard tables etc.

After the initial exposure period, Pynefloor products must not get wet. (See *Wet Area Floors for protection of the product*).

Sufficient sub floor ventilation must be provided under all platform floors suspended above the ground to ensure the ongoing moisture content of the flooring panels remains at or below 16% over the life of the product. Subfloor ventilation requirements as set out in NZS 3604 6.14 shall be regarded as the minimum levels required.

Pynefloor™ products must not be used:

- In an exterior location, or where intermittent wetting might occur.
- In spa pool rooms.
- As a substrate for roofing or decking membranes.
- In a permanently raw unfinished condition – (prior to occupation of the building, Pynefloor must be sealed or covered with an appropriate floor covering).

Once installed and in use, panels must not be subjected to conditions that will allow the continuing moisture content to be above 16%.

All design considerations cannot be provided in this brochure. Please refer to the Pynefloor Technical Manual for a more comprehensive list of considerations. This manual gives full details of Pynefloor products' physical properties, commercial and industrial applications, installation, large floor areas and finishing and maintenance.

Exposure

Pynefloor Straight Edge and Pynefloor Green Tongue must not be exposed to weathering for more than eight weeks.

Pynefloor Gold must not be exposed to weathering for more than twelve weeks.

The products must be left to weather in their manufactured state. Application of protective coatings or coverings to the surface of Pynefloor during weathering must not occur.

Identification

Each Pynefloor sheet has an identifying label on the underside and is also clearly ink marked, with the brand name and julian date.

Storage

Pynefloor must be stacked clear of the ground, on evenly spaced, full width timber bearers, at centres that will not allow sheets to sag. Storage on site must be under a well ventilated cover, to protect from moisture and sunlight.

Features and benefits

Pynefloor™ products:

- Can be laid in all weathers.
- Can be walked on immediately.

Pynefloor™ Green Tongue™:

- No nogs are required, therefore less nailing.
- Optimum sizes (four sizes to suit all situations).
- Fast continuous installation.

Pynefloor™ Gold™ is the premium particleboard:

- Designed specifically for 600mm joist spacings.
- Close-in period has been extended by an additional 50% to twelve weeks.

NZ Building Code

Pynefloor meets the requirements of NZS 3604 for sheet flooring. NZS 3604 being an acceptable solution referred to in the New Zealand Building Code – Clause B1 Structure.

When stored, handled, installed and maintained in accordance with instruction set out in the Pynefloor Technical Manual, Pynefloor panels will meet the durability performance requirements of NZBC B2.3.1(a) for 50 years.

Pynefloor Straight Edge, Pynefloor Green Tongue and Pynefloor Gold have been appraised by BRANZ – Appraisal Certificate number 254 (2006) for use under NZBC B2.3(a) for 50 year durability.

This brochure must be read in conjunction with the current Pynefloor Technical Manual.

Other literature available on request includes:

- Trade Essentials Technical Bulletin: Pynefloor Particleboard in Wet Area Floors.

The Laminex Group™ will not be liable to any person if the instructions as to storage, use and installation of Pynefloor as outlined in this brochure or referenced literature are not complied with.

It is the obligation of the installer of Pynefloor to communicate the information conveyed in this brochure to the relevant owner/occupier.

Any proprietary products referred to in this brochure must be used in accordance with the relevant manufacturer's instructions. The Laminex Group accepts no liability for these proprietary products. Nothing contained in this paragraph or elsewhere in this brochure affects any rights a person may have under the Consumer Guarantees Act 1993.

This brochure supersedes all previous issues.

All Acts, Codes and Standards referred to in this brochure are the current editions at the date of brochure publication.

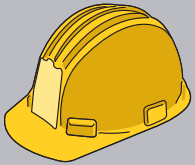

Health and Safety

Health and safety precautions must be taken when working with wood products.

- Exposure to wood dust and/or to formaldehyde may cause irritation to the eyes, respiratory system and skin, and may cause sensitisation resulting in asthma, and by skin contact resulting in dermatitis.
- Wood dust is classified as a known carcinogen. Repeated inhalation of wood dust over many years may cause nasal cancer. Formaldehyde is classified as a known carcinogen.
- Storage areas containing large quantities of Pynefloor must be adequately ventilated.
- Work areas must be well ventilated and kept clean. Sawing, sanding and machining equipment must be fitted with dust extractors to ensure that dust levels are kept within standards laid down by Worksafe Australia, Occupational Health and Safety New Zealand, or the specific country of use. If not, a dust mask conforming with AS/NZS 1715 and AS/NZS 1716 and eye protection conforming with AS/NZS 1337 must be worn.
- Offcuts, shavings and dust must be disposed of in a manner which avoids the generation of dust and in accordance with the requirements of local waste authorities.
- In end use applications all product surfaces exposed to occupied space must be sealed. For further information and material safety data sheets, please phone The Laminex Group™ Customer Services Department.

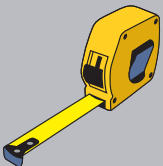

Technical Support:

As not all product use options can be described in this brochure, additional end use and specifying information is available as a complimentary service. The information contained in this brochure must not be reproduced or published in whole or in part without the prior consent of The Laminex Group. The Laminex Group reserves the right to revise without notice any information contained in this brochure. Please contact The Laminex Group Customer Services Department to check the currency of information contained in this brochure.

Contact Details:

For more product information or order enquiries please phone **The Laminex Group** on **0800 303 606** to speak with a representative from The Laminex Group or fax **0800 303 707**.

www.thelaminexgroup.co.nz